

*draft*



# Rollingwood Park

## MASTER PLAN

Appendix B  
ADA Trail  
April 2019

# PARK CHARACTER



PLAYGROUND

SPORTS FIELDS

NATIVE GARDEN

TEMPORARY POLICE HEADQUARTERS

LARGE TREES

DRAINAGE PATHWAY

*view to upper sports fields*



existing stairs



view to parking



existing social trail to lower park



drainage patterns

## PARK CONTEXT

The proposed ADA Trail connection will greatly increase the usability of both the upper and lower park areas, making them more easily accessible by foot, bicycle, wheelchair or even with a stroller. It will serve the community by linking City Hall and its surrounding outdoor spaces to the Park, providing a more continuous experience of the 8 acre amenity.

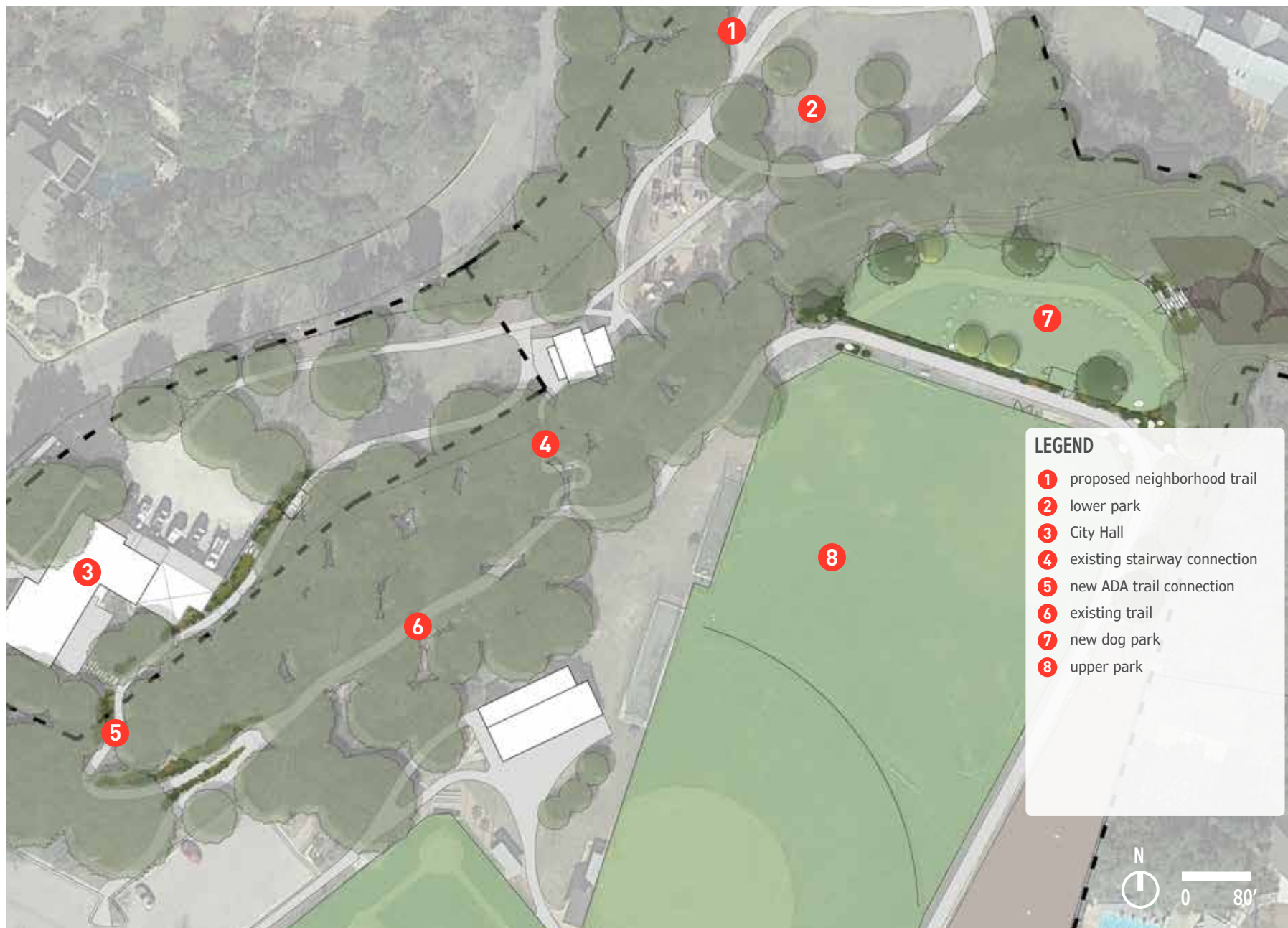

# ADA TRAIL PLAN

Here, the new ADA trail connects the upper and lower park areas in more direct and fluid manner. By making this connection right behind City Hall, the building will become more integrated and embedded in the residents Park experience. The ADA connection will draw people to the lower pavilion and assist all users in their ability to traverse the steep slopes. New native gardens will expand the beloved City Hall gardens that already exist. In addition, the strategic use of biofiltration gardens will assist with existing drainage and erosion issues.



# MATERIALS

The proposed materials palette for this park update is simple and aligned with what is already on site. Concrete will be used as needed and in some locations decomposed granite may also be utilized in order to limit impervious cover. Stone steps will be used to make additional connections. Retaining walls and handrails will be used when necessary to traverse the bluff. Native plants that comply with City standards are recommended for use throughout the Park. One of the overall recommendations for the Park in the Master Plan suggests that existing native gardens on-site be expanded. In addition, the Master Plan suggests that drainage and stormwater issues should be resolved through strategic siting of biofiltration gardens. Vegetation can also be utilized to limit erosion on steep slopes. Signage may be used to educate the public about the Park amendments.



*stone steps*



*decomposed granite*



*concrete*



*rain gardens*





signage



native gardens



retaining wall + handrail

